

9

8

0.100" (2.54)

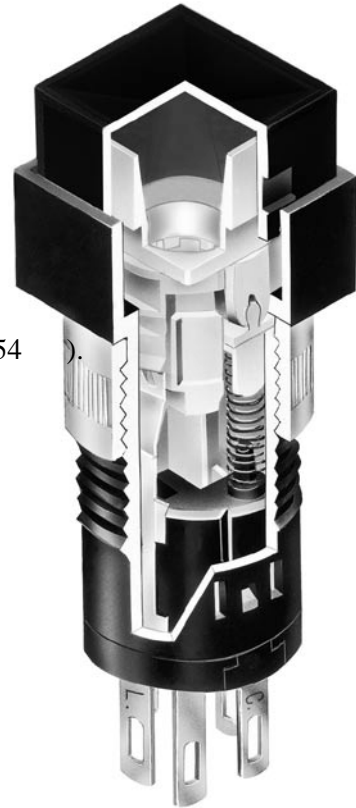

M.

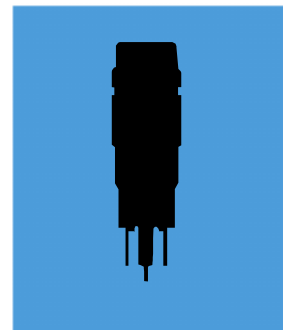

S .354" (9.0)

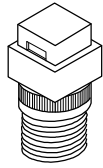

C .354" (9.0)



.020" ~ .197"
(0.5 ~ 5.0)

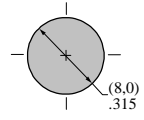

AT110

AT073

K

W01

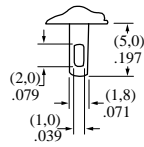

0.1A

30

x .200" (2.54 x 5.08)

.100"

= (0.3)
.012

0.080" (2.03)

:

AT4035

AT4036

A

()

C

F

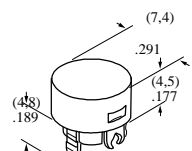
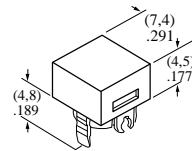

B

E

G

:

:

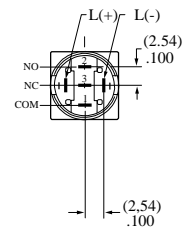
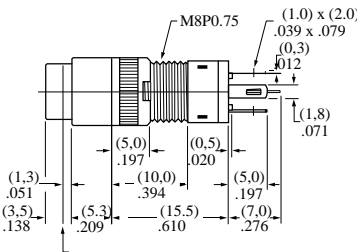
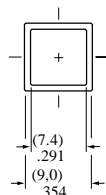

HB15SKW01-C

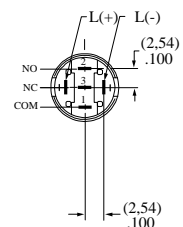
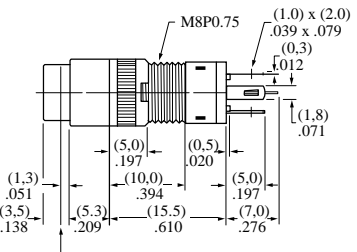
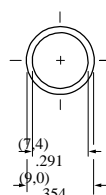

HB16CKW01-C